



**SUSTAINABLE ENERGY
WEEK 15-19 JUNE 2015**
Take part in shaping Europe's sustainable energy future



The MED Programme, committed to a decarbonized Mediterranean:

**Innovation for Renewable Energy and Energy Efficiency solutions in Mediterranean
regions and cities. An overview of achieved results**

Bruxelles, 18th June 2015

Promotion of Port Communities SMEs role in Energy Efficiency and GREEN technologies for BERTHING operations

GREEN BERTH

Federico Torres
Port Authority of Valencia
Project Manager



Programme cofinancé par le Fonds Européen
de Développement Régional
Programme cofinanced by the European Regional
Development Fund

with the support of the projects



and



LEADER



PARTNERS



LUKA UPRAVA RIJKA
PORT OF RIJKA AUTHORITY



TECHNOLOGICAL



ADVISORY BOARD



Programme cofinancé
de Développement Régional
Programme cofinanced by the European
Development Fund

with the support of the projects

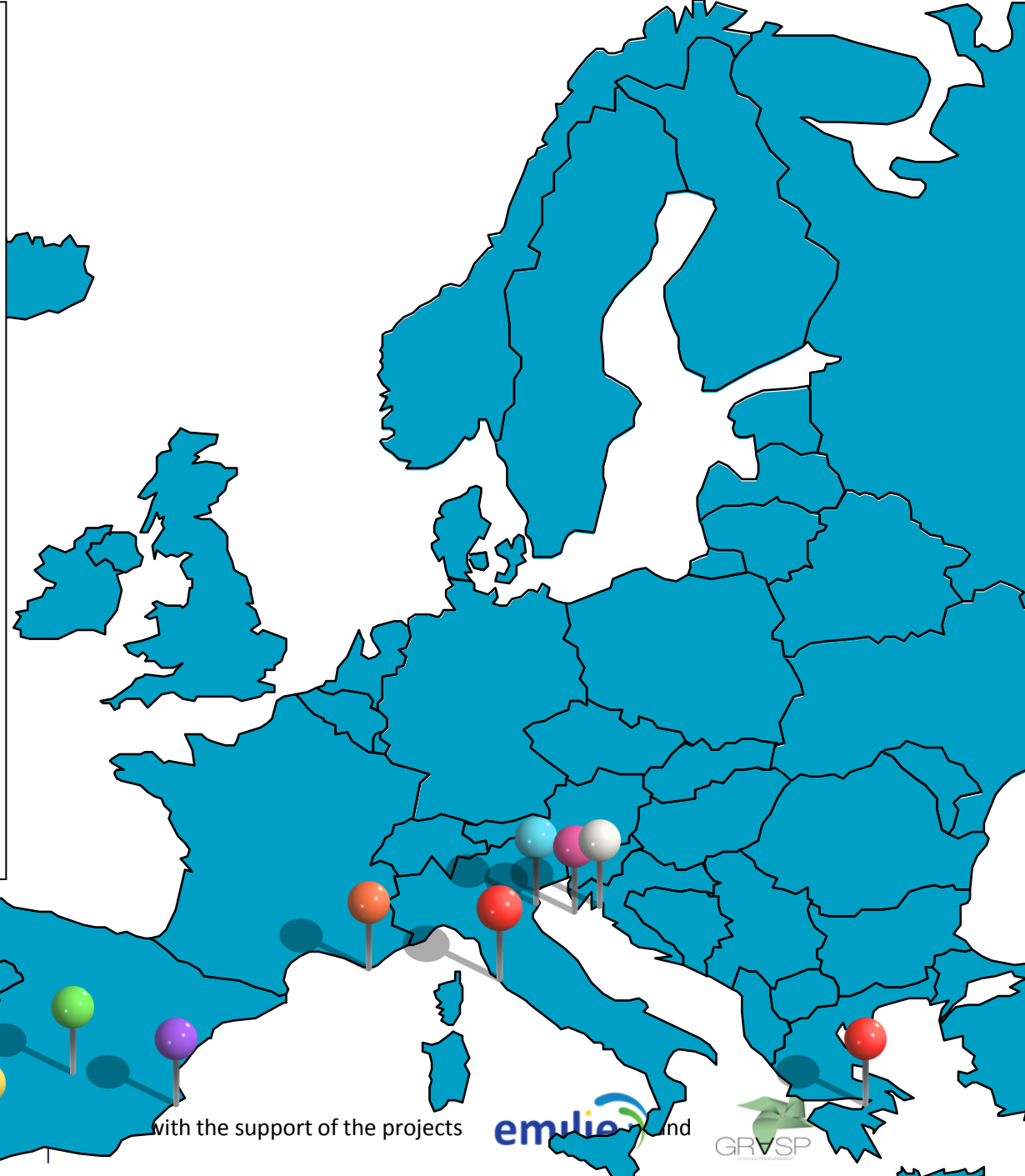

THE PROJECT IN A NUTSHELL

MAIN THEME:

Improvement of the Energy Efficiency and development of clean technologies in the Port Communities located in the Mediterranean Basin and the definition of the access of the SMEs to the Energy Port Scheme.

PARTNERSHIP:

6 ports from the Mediterranean Sea, 2 technological partners related to Energy Efficiency and Renewable Energy and 1 capitalization partner to coordinate all the partnership.

TARGET GROUP(S):

- Energy specialised SMEs
- Port operators

OBJECTIVE:

Development of an Energy Assessment Methodology and Energy Strategic Plans for Mediterranean Ports, including the SMEs in the process of implementation.



Programme cofinancé par le Fonds Européen
de Développement Régional
Programme cofinanced by the European Regional
Development Fund

with the support of the projects



and



THE PROJECT STORY

BACKGROUND: WHAT'S THE PROBLEM THE PROJECT FACED?

VESSELS AND OPERATION AT PORTS, WHY?

- ❑ The vessel impact is almost 45% of the GHG emissions at port areas.
- ❑ The Nautical Port Services (towage, mooring, pilotage, etc.) emissions are a 14%
- ❑ The port machinery is over a 25%
- ❑ Road transportation is over 12 %



ACHIEVED RESULTS

C) Pilot actions developed

- c.1. Cold Ironing
- c.2. Energy Management System
- c.3. Renewable energy implementation
- c.4. LNG feasibility for port operations

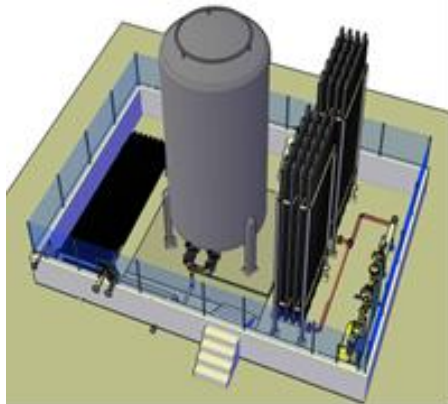
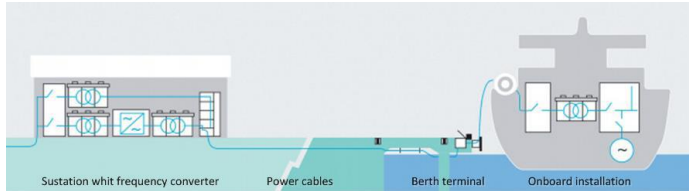

RESULT	IMPACT	REPLICATION & CAP.
A	EE in decision making	Yes / Adaptable
B	RES implementation assessment	100% Adaptable
C	SMEs involvement in EE implementation	Yes / Adaptable

Thank you for your kind attention!

Federico Torres
Port Authority of Valencia
Project Manager
email: ftorres@valenciaport.com
www.greenberth.eu



Programme cofinancé par le Fonds Européen
de Développement Régional
Programme cofinanced by the European Regional
Development Fund

with the support of the projects

